



Oasis Pro 20 Premium CLEANER & DISINFECTANT

The **Oasis Pro Premium** professional cleaning system provides ultra-concentrated products for high-end performance. **Oasis Pro 20 Premium** is an all purpose cleaner disinfectant that kills germs and fungi on all food preparation areas and equipment. **Oasis Pro 20 Premium** is bactericidal according to EN 13697 at 350ml/10L (3.5%) / 1 minute; bactericidal according to EN 1276 at 100ml/10L (1%) / 5 minutes.

- **Performance:** Oasis Pro 20 Premium cleans and disinfects at the same time.
- **Efficiency:** Accurate dilution of Oasis Pro 20 Premium provides excellent results and low costs.
- **Safety:** EN registered broad spectrum formulation maintains highest level of anti-microbial protection.



USE INSTRUCTIONS

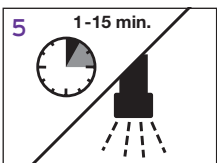
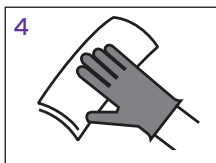
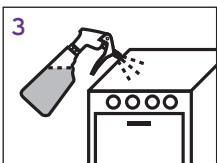
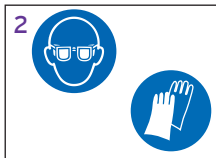

- 1 Check hygiene plan, product label and safety information for detailed use information.
- 2 Wear suitable protective clothing when handling the undiluted product.
- 3 Spray **Oasis Pro 20 Premium** by using a foam sprayer on surface.
- 4 Wipe with wet sponge/cloth.
- 5 Leave in contact for 1 - 15 minutes. Rinse surface with clean water. Allow surface to air dry.

SPECIAL NOTES / INFORMATION

For professional use only!

Prepare ready-to-use solution by using the Ecolab Dosing Equipment.

Recommended use-concentration:
1 - 3.5 % depending on soil level, water hardness and EN Norms.

Active ingredients:
7,5 g Benzalkoniumchloride and 4,0 g Lauryldipropylentriamine

SAFETY INFORMATION

Do not mix with any other product! Wear protective gloves and safety glasses when you exchange the empty pouch with a new one. Dispose of packaging only if emptied and closed. Product residues: see Safety Data Sheet.

Use cleaner disinfectant safely. Always read the label and product information before use.

For further information and safety instructions see product label and safety data sheet.

STORAGE CONDITIONS

Store between 0 °C and 35 °C in original closed container only.

PACK SIZE

2 x 2 L